

# Legend

## 2035 No-Build Peak Hour Level of Service

- A/ B/ C
- D
- E/ F
- Signalized Intersection
- ▲ Unsignalized Intersection
- ▭ Exit 9 (Benson Road) Study Area

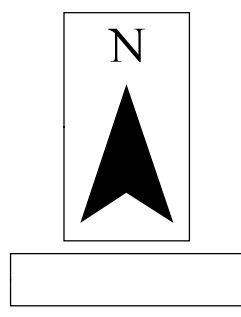

# EXIT 9

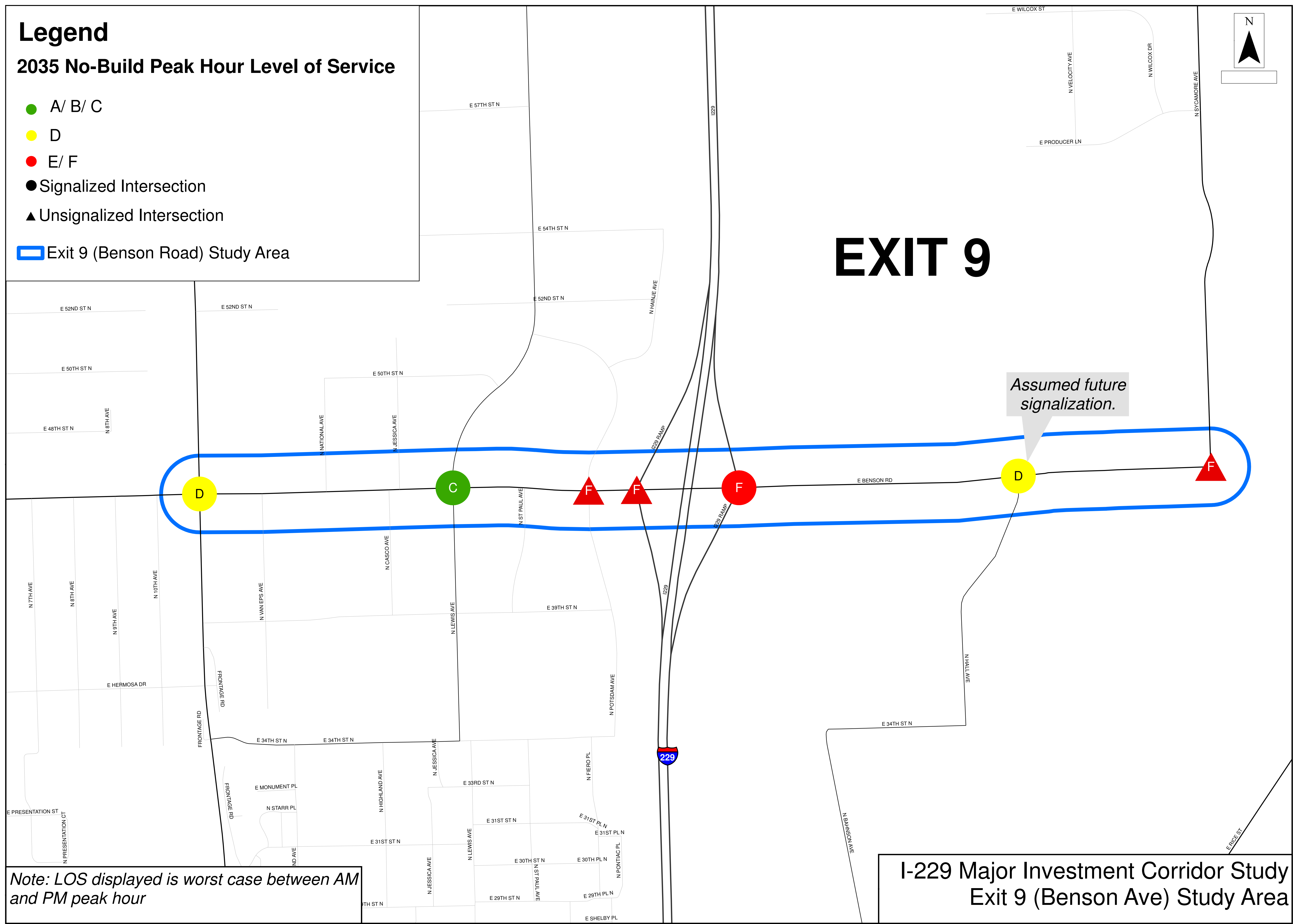

Note: LOS displayed is worst case between AM and PM peak hour

I-229 Major Investment Corridor Study  
Exit 9 (Benson Ave) Study Area